

INSULATION PLUGS

IPL 60 & IPL 95

NEW! FASTEN LIGHTWEIGHT OBJECTS DIRECTLY INTO THERMAL INSULATION BOARDS!

- Suitable base materials are clean or plastered EPS-, XPS- and polyurethane thermal insulation boards
- No predrilling needed - Sharp cutting tip penetrates through plaster layer and fiberglass mesh*
- Weather resistant and robust polyamid prevents cold-bridging
- Plugs are white half-transparent colored and can be painted over!



QUICK, SECURE AND EASY FASTENING OF...



MAILBOXES, MOTION DETECTORS, SIGNS...



LAMPS AND OTHER LIGHT OBJECTS!



IPL 60



IPL 95

* Tested in 0...7 thick cement plastering reinforced with a fiberglass mesh. Please note that plastering materials, thickness and quality may vary greatly. If plaster layer thickness and/or other specifics are unknown we recommend doing a test installation.

INSTALLATION PARAMETERS AND CAPACITIES

TYPE	L	L ₁	D	D ₂	SCREW Ø	PERMISSIBLE LOADS (kN)	
						EPS PS15 (15 kg/m ³)	EPS PS20 (20 kg/m ³)
	mm	mm	mm	Drive	mm		
IPL 60	58	30 + t _{fix}	25	T40	✦ 4,5 - 5,0	50 N (~5 kg)	
IPL 95	97	40 + t _{fix}	32	SW13	● 8,10, M8	100 N (~10 kg)	

L Total length t_{fix} Fixture thickness L₁ Screw length D Plug head diameter D₂ Plug drive

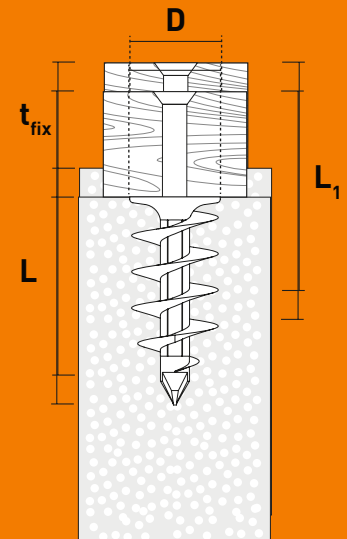

RANGE AND PACKAGES

TYPE	CODE	PACKAGES	WEIGHT
		BOX/OUTER BOX	KG/1000 PCS
IPL 60 INSULATION PLUG	75130	30 / 300	6,0
IPL 95 INSULATION PLUG	75132	20 / 200	20,3



INSTALLATION INSTRUCTIONS

IPL 60 installation

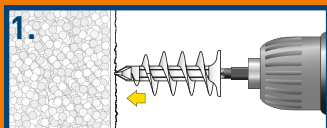

1. Use a T40 screw drive. Push the plug tip slightly into the base material.

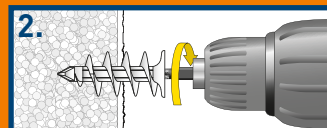

2. Screw the plug in using an electric driver.

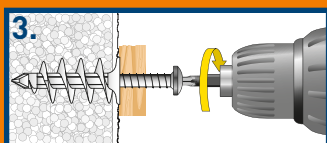

3. Attach the fixture with a suitable screw.

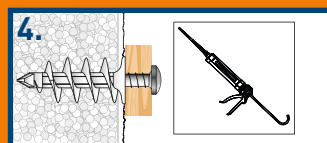

4. Done! We recommend using silicone sealing under the plug collar to prevent water entering the insulation material.

IPL 95 installation

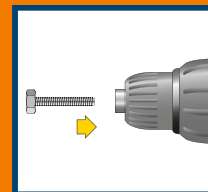

Use the included M8x25 screw bolt as a setting tool.

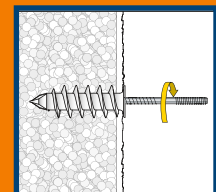

IPL 95 -plug works also with M8/M10 hanger bolts for fastening e.g. down-pipes!

Set the screw bolt into the drill socket thread first.

Installation as with IPL 60.